

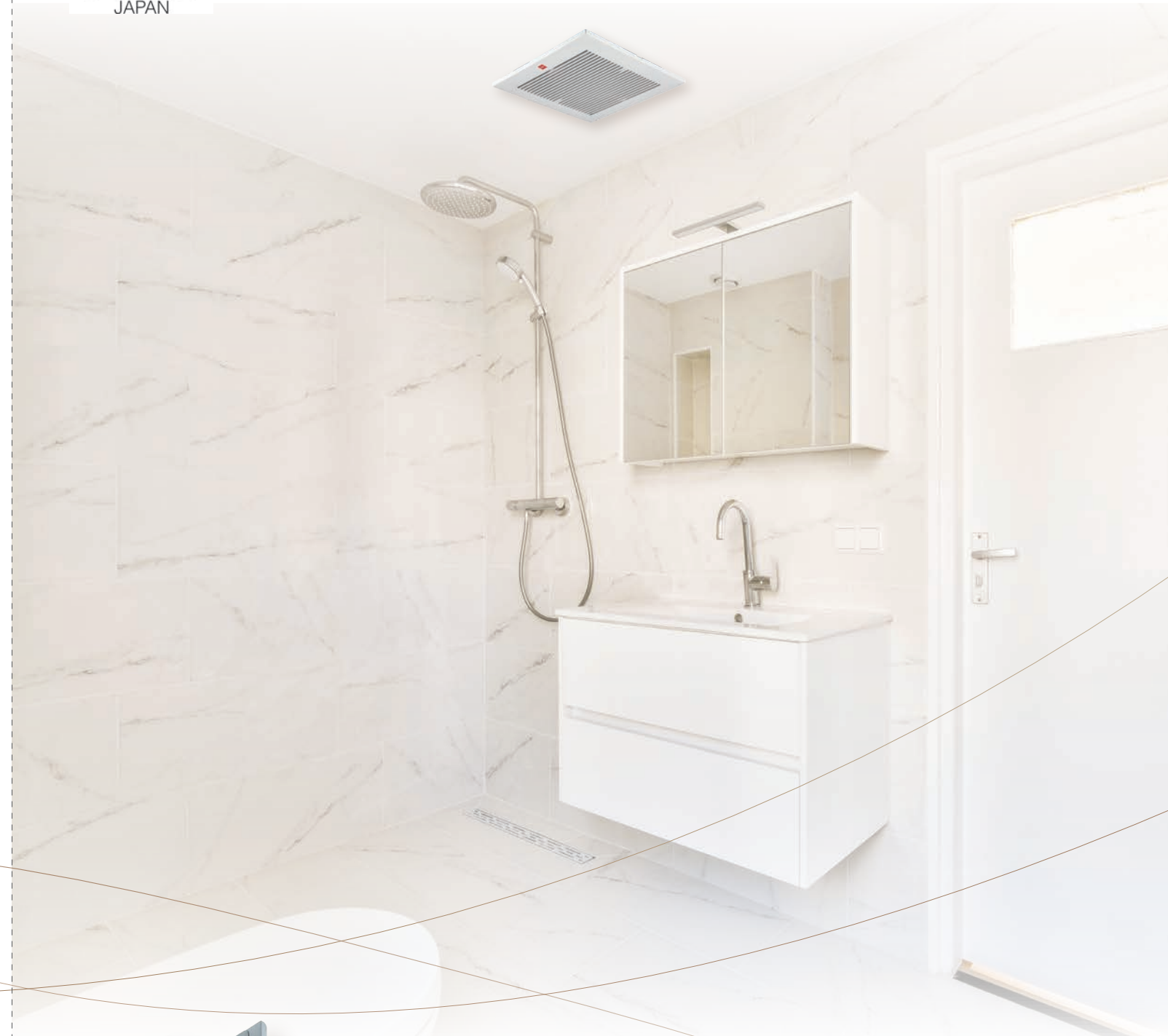

SINCE 1909
JAPAN



CEILING-MOUNT

VENTILATING FAN

For Your Fresh Breath of Living



KDK Company, Division of PES
4017, Takaki-cho, Kasugai, Aichi, Japan
<http://kdk.jp>

• Actual colors may vary slightly from those shown.
• Specifications are subject to change without prior notice.

CATALOG NO: K-AMCA009
February 2023

General Feature For Super Quiet Series, Standard Series and DC Motor Series

Achieve reduction of power consumption and noise by the optimized product structure



Long Life

- The unique design of HP (Half Pitch) motor, incorporates with well lubricated ball bearings, temperature rise is reduced that prolongs motor lifetime and product durability
- Frame assembly made of ZAM alloy coated steel enhances rust protection
- Louver adopts PP material that is comparatively higher chemical resistant and weatherability than ABS material of previous model

Highly Efficient

- Taper blade design effectively controls the turbulence surrounding the blade. Strong and smooth ventilation performance is achieved while noise level is reduced, by whole of the blade
- Curve-shaped backdraft shutter results in further improvement of air tightness and strength

Super Low Noise

- The integrated casing and orifice minimizes the transmission of noise from the fan and motor to exterior. This technology further reduces the operation noise to incredibly low level by "Resonance-Noise-Absorption" operation, which creates a tranquility and silent environment for your life

Easy Installation

- Cassette type discharge adaptor facilitating installation of the product, as well as duct connecting work
- Spring-clip louver allows convenient installation and removal of louver

General Feature For Metal Series

24CMUA / 24CMHA



High Performance

- Sirocco fan sustains high static pressure induced by long duct and reduces noise level
- Unique seam-processed casing ensures strength and hermetic sealing
- Reverse flow prevention shutter results in further improvement of air tightness

Easy Installation & Maintenance

- Detachable duct adaptor makes installation simply
- Spring-clip louver allows easy removal for cleaning

Safe

- Motor with thermal cut-off fuse prevents fire induced by overheat
- Metallic structure within air stream provides extra safety against fire*

Durable

- Painted steel frame enhances anti-rust capability
- HP (Half Pitch) motor and ball bearing enable continuous operation for years

* Metallic structure can reduce the fire risk spread to other area from the affected compartment through the ducting.

Super Quiet Series



17CUH

- HP (half pitch) motor with ball bearing
- Taper blade sirocco fan
- Curve-shaped backdraff shutter
- Super low noise level
- Motor insulation Class B



Panasonic Electric Works Vietnam Co., Ltd. certifies that the Super Quiet Series models shown herein are licensed to bear the AMCA Seal. The ratings shown are based on tests and procedures performed in accordance with AMCA Publication 211 and AMCA Publication 311 and comply with the requirements of the AMCA Certified Ratings Program.

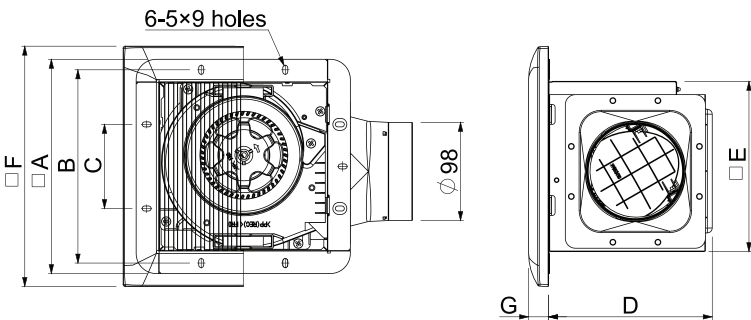

Unit: mm

A	B	C	D	E	F	G	Duct Size
214	194	84	164	170	240	20	Ø100

Model	Voltage [V]	Frequency [Hz]	CFM / SONE AT STATIC Pressure (ps-inches of H ₂ O)				RPM	Watts*	Watts**
			Inches of H ₂ O	0	0.1	0.125			
17CUH	220	60	CFM	44	32	29	664	10	10
			Sones	0.3	0.5	0.6			
	240	50	CFM	51	43	40	728	10	9.5
			Sones	0.3	0.4	0.5			

Performance certified is for installation type B: Free inlet, Ducted outlet. Performance ratings include the effects of an inlet grille and backdraft shutter. Speed (RPM) shown is nominal. Performance is based on actual speed of test. The sound ratings shown are loudness values in fan sones at 5 ft. (1.5m) in a hemispherical free field calculated per AMCA International Standard 301. Values shown are for installation type B: Free inlet hemispherical sone levels.
* the Watts rating is for AMCA test method and it is at the static pressure of 0 inch of H₂O.
** the Watts rating is only for IEC test method and the AMCA Certified Rating Seal does not apply to IEC test method watts.

Super Quiet Series



24CUH/24CDH/24CHH/24CGH

- HP (half pitch) motor with ball bearing
- Taper blade sirocco fan
- Curve-shaped backdraff shutter
- Super low noise level
- Motor insulation Class B



Panasonic Electric Works Vietnam Co., Ltd. certifies that the Super Quiet Series models shown herein are licensed to bear the AMCA Seal. The ratings shown are based on tests and procedures performed in accordance with AMCA Publication 211 and AMCA Publication 311 and comply with the requirements of the AMCA Certified Ratings Program.

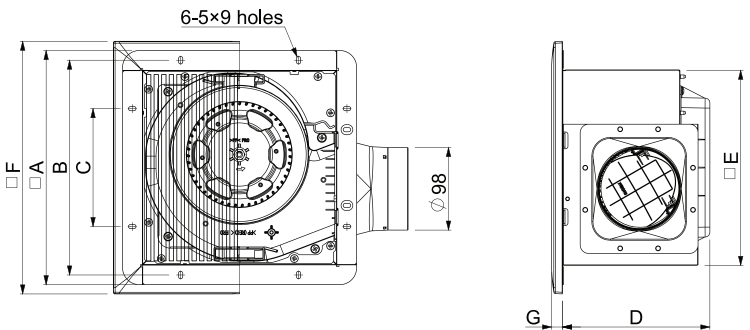

Unit: mm

A	B	C	D	E	F	G	Duct Size
278	255	140	175	233	300	13	Ø100

Model	Voltage [V]	Frequency [Hz]	CFM / SONE AT STATIC Pressure (ps-inches of H ₂ O)						RPM	Watts*	Watts**
			Inches of H ₂ O	0	0.1	0.125	0.25	0.375			
24CUH	220	60	CFM	83	73	68	46	-	585	13	13.5
			Sones	0.4	0.5	0.6	1.3	-			
	240	50	CFM	89	77	75	51	-	614	13	12
			Sones	0.5	0.7	0.7	1.4	-			
24CDH	240	50	CFM	106	93	89	65	-	782	17	16.5
			Sones	0.9	0.9	0.9	1.6	-			
24CHH	220	60	CFM	109	99	96	75	48	791	22	20.5
			Sones	1.0	0.9	1.0	1.3	2.2			
	240	50	CFM	117	109	96	73	33	861	21	19.5
			Sones	1.2	1.2	1.2	1.3	1.8			
24CGH	220	60	CFM	121	113	111	97	77	888	27	26.5
			Sones	1.7	1.8	1.8	2.0	2.6			
	240	50	CFM	130	118	115	90	43	955	27	25.5
			Sones	2.1	1.9	1.8	1.9	2.5			

Performance certified is for installation type B: Free inlet, Ducted outlet. Performance ratings include the effects of an inlet grille and backdraft shutter. Speed (RPM) shown is nominal. Performance is based on actual speed of test. The sound ratings shown are loudness values in fan sones at 5 ft. (1.5m) in a hemispherical free field calculated per AMCA International Standard 301. Values shown are for installation type B: Free inlet hemispherical sone levels.
* the Watts rating is for AMCA test method and it is at the static pressure of 0 inch of H₂O.
** the Watts rating is only for IEC test method and the AMCA Certified Rating Seal does not apply to IEC test method watts.

Super Quiet Series



27CHH

- Super low noise design
- Long life ball bearing motor
- Taper blade sirocco fan
- Resonance-Noise-Absorption Structure
- Pre-installed power cord
- 2-speed selectable



Panasonic Ecology Systems Guangdong Co., Ltd. certifies that the Super Quiet Series models shown herein are licensed to bear the AMCA Seal. The ratings shown are based on tests and procedures performed in accordance with AMCA Publication 211 and AMCA Publication 311 and comply with the requirements of the AMCA Certified Ratings Program.

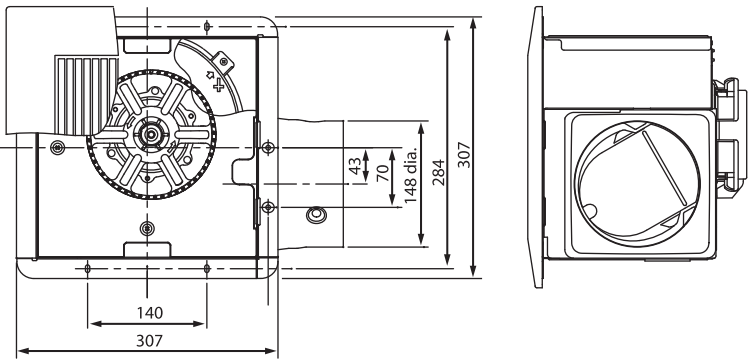
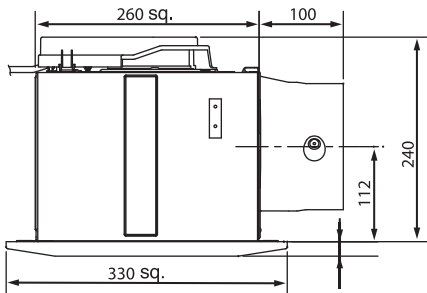

Model	Voltage [V]	Frequency [Hz]	Speed	CFM / SONE AT STATIC Pressure (ps-inches of H ₂ O)							RPM	Watts*	Watts**
				Inches of H ₂ O	0	0.1	0.125	0.25	0.375	0.5			
27CHH	220	60	Hi	CFM	182	162	156	118	78	37	570	33	33
				Sones	1.1	1.2	1.3	1.7	2.2	2.5			
	240	50	Hi	CFM	198	179	172	126	78	18	609	37	34
				Sones	1.4	1.5	1.6	1.8	2.3	2.5			

Performance certified is for installation type B: Free inlet, Ducted outlet. Performance ratings include the effects of an inlet grille and backdraft shutter. Speed (RPM) shown is nominal. Performance is based on actual speed of test. The sound ratings shown are loudness values in fan sones at 5 ft. (1.5m) in a hemispherical free field calculated per AMCA International Standard 301. Values shown are for installation type B: Free inlet hemispherical sone levels.
* the Watts rating is for AMCA test method and it is at the static pressure of 0 inch of H₂O.
** the Watts rating is only for IEC test method and the AMCA Certified Rating Seal does not apply to IEC test method watts.

Super Quiet Series



32CDH

- Super low noise design
- Long life ball bearing motor
- Taper blade sirocco fan
- Resonance-Noise-Absorption Structure
- Pre-installed power cord
- 2-speed selectable



Panasonic Ecology Systems Guangdong Co., Ltd. certifies that the Super Quiet Series models shown herein are licensed to bear the AMCA Seal. The ratings shown are based on tests and procedures performed in accordance with AMCA Publication 211 and AMCA Publication 311 and comply with the requirements of the AMCA Certified Ratings Program.

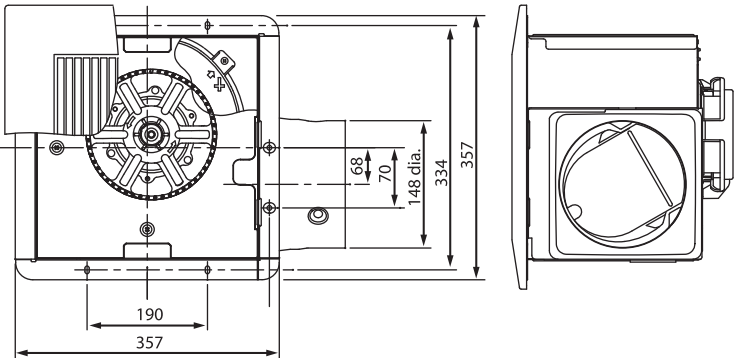
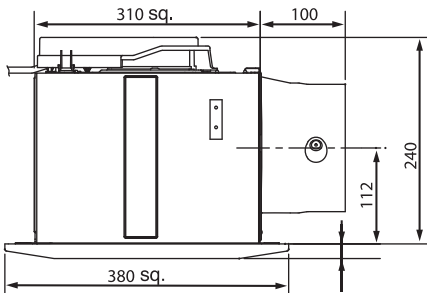

Model	Voltage [V]	Frequency [Hz]	Speed	CFM / SONE AT STATIC Pressure (ps-inches of H ₂ O)								RPM	Watts*	Watts**
				Inches of H ₂ O	0	0.1	0.125	0.25	0.375	0.5	0.625			
32CDH	220	60	Hi	CFM	226	202	196	163	127	91	53	580	48	48
				Sones	1.2	1.3	1.4	1.7	2.2	2.7	3.3			
	240	50	Hi	CFM	257	236	230	192	147	99	53	675	56	50
				Sones	1.6	1.7	1.8	1.9	2.5	3.0	3.6			

Performance certified is for installation type B: Free inlet, Ducted outlet. Performance ratings include the effects of an inlet grille and backdraft shutter. Speed (RPM) shown is nominal. Performance is based on actual speed of test. The sound ratings shown are loudness values in fan sones at 5 ft. (1.5m) in a hemispherical free field calculated per AMCA International Standard 301. Values shown are for installation type B: Free inlet hemispherical sone levels.
* the Watts rating is for AMCA test method and it is at the static pressure of 0 inch of H₂O.
** the Watts rating is only for IEC test method and the AMCA Certified Rating Seal does not apply to IEC test method watts.

DC Motor Series



24JRB

- DC (Direct Current) motor
- Auto operation by motion sensor
- Constant airflow
- Variable air volume
- Delay timer (15 minutes)
- Resonance-Noise-Absorption Structure



Panasonic Ecology Systems Guangdong Co., Ltd. certifies that the DC Motor models shown herein are licensed to bear the AMCA Seal. The ratings shown are based on tests and procedures performed in accordance with AMCA Publication 211 and AMCA Publication 311 and comply with the requirements of the AMCA Certified Ratings Program.

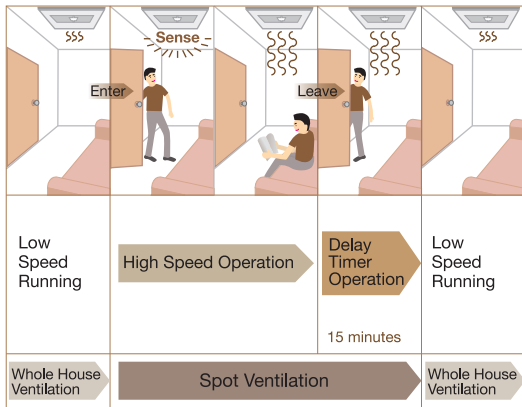
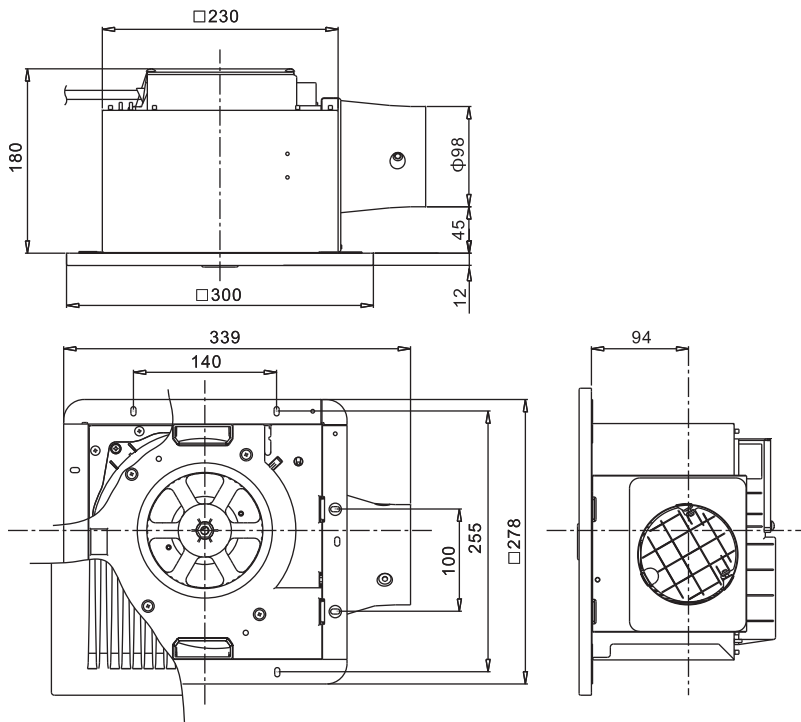

The operation is activated by motion sensor.

Model	Voltage [V]	Frequency [Hz]	Speed	CFM / SONE AT STATIC Pressure (ps-inches of H ₂ O)								RPM	Watts*	Watts**
				Inches of H ₂ O	0	0.1	0.125	0.25	0.375	0.5	0.625			
24JRB	220	60	Hi	CFM	88	88	88	88	63	34	5	853	10	8
				Sones	0.7	1.0	1.0	1.3	1.7	1.8	3.1			
	240	50	Hi	CFM	88	88	88	88	63	34	5			
				Sones	0.7	1.0	1.0	1.3	1.7	1.8	3.1			

Performance certified is for installation type B: Free inlet, Ducted outlet. Performance ratings include the effects of an inlet grille and backdraft shutter. Speed (RPM) shown is nominal. Performance is based on actual speed of test. The sound ratings shown are loudness values in fan sones at 5 ft. (1.5m) in a hemispherical free field calculated per AMCA International Standard 301. Values shown are for installation type B: Free inlet hemispherical sone levels.
* the Watts rating is only for AMCA test method and it is at the static pressure of 0 inch of H₂O.
** the Watts rating is only for IEC test method and the AMCA Certified Ratings Seal does not apply to IEC test method watts.

DC Motor Series



24JAB

- DC (Direct Current) motor
- Constant airflow
- Variable air volume
- Delay timer (15 minutes)
- Resonance-Noise-Absorption Structure



Panasonic Ecology Systems Guangdong Co., Ltd. certifies that the DC Motor models shown herein are licensed to bear the AMCA Seal. The ratings shown are based on tests and procedures performed in accordance with AMCA Publication 211 and AMCA Publication 311 and comply with the requirements of the AMCA Certified Ratings Program.

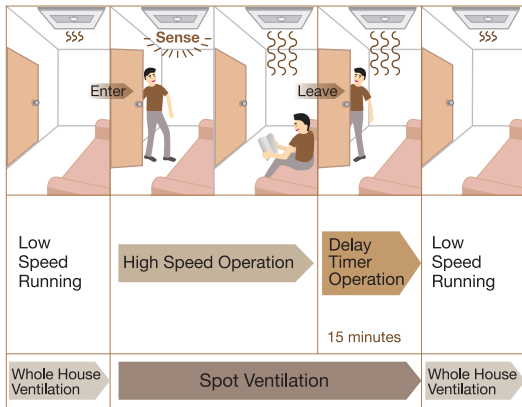
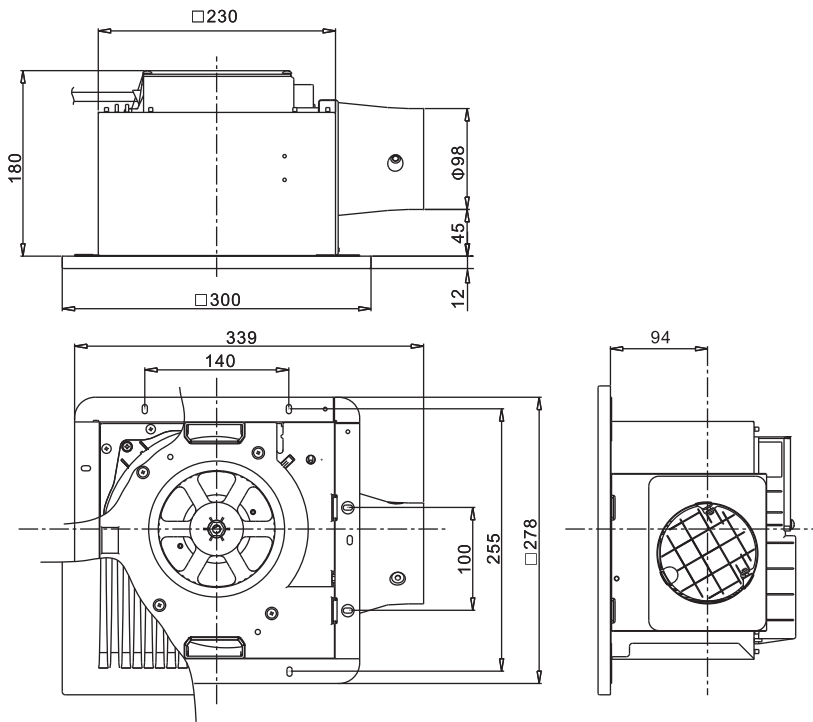

The operation is activated by motion sensor.

Model	Voltage [V]	Frequency [Hz]	Speed	CFM / SONE AT STATIC Pressure (ps-inches of H ₂ O)								RPM	Watts*	Watts**
				Inches of H ₂ O	0	0.1	0.125	0.25	0.375	0.5	0.625			
24JAB	220	60	Hi	CFM	88	88	88	88	63	34	5	839	10	8
				Sones	0.6	0.9	1.0	1.4	1.6	1.9	3.2			
	240	50	Hi	CFM	88	88	88	88	63	34	5			
				Sones	0.6	0.9	1.0	1.4	1.6	1.9	3.2			

Performance certified is for installation type B: Free inlet, Ducted outlet. Performance ratings include the effects of an inlet grille and backdraft shutter. Speed (RPM) shown is nominal. Performance is based on actual speed of test. The sound ratings shown are loudness values in fan sones at 5 ft. (1.5m) in a hemispherical free field calculated per AMCA International Standard 301. Values shown are for installation type B: Free inlet hemispherical sone levels.
* the Watts rating is only for AMCA test method and it is at the static pressure of 0 inch of H₂O.
** the Watts rating is only for IEC test method and the AMCA Certified Ratings Seal does not apply to IEC test method watts.

Metal Series



24CMUA/24CMHA

- All metal structure design
- Long life ball bearing motor
- Metallic components within air stream provides extra safety against fire
- Reverse flow prevention shutter



Panasonic Ecology Systems Guangdong Co., Ltd. certifies that the Metal Series models shown herein are licensed to bear the AMCA Seal. The ratings shown are based on tests and procedures performed in accordance with AMCA Publication 211 and AMCA Publication 311 and comply with the requirements of the AMCA Certified Ratings Program.

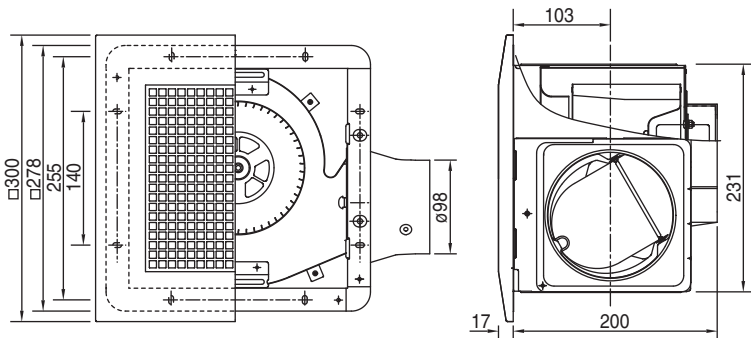

Model	Voltage [V]	Frequency [Hz]	CFM / SONE AT STATIC Pressure (ps-inches of H ₂ O)					RPM	Watts*	Watts**
			Inches of H ₂ O	0	0.1	0.125	0.25			
24CMUA	220	60	CFM	55	40	37	20	495	13	12
			Sones	0.3	0.7	0.8	1.6			
	240	50	CFM	55	44	41	24	562	14	13
			Sones	0.3	0.8	1.0	1.4			
24CMHA	220	60	CFM	94	85	83	72	681	25	23
			Sones	1.0	1.4	1.5	1.9			
	240	50	CFM	108	98	95	77	753	27	25
			Sones	1.4	1.8	1.9	2.1			

Performance certified is for installation type B: Free inlet, Ducted outlet. Performance ratings include the effects of an inlet grille and backdraft shutter. Speed (RPM) shown is nominal. Performance is based on actual speed of test. The sound ratings shown are loudness values in fan sones at 5 ft. (1.5m) in a hemispherical free field calculated per AMCA International Standard 301. Values shown are for installation type B: Free inlet hemispherical sone levels.
* the Watts rating is only for AMCA test method and it is at the static pressure of 0 inch of H₂O.
** the Watts rating is only for IEC test method and the AMCA Certified Ratings Seal does not apply to IEC test method watts.

Metal Series



27CMHA

- All metal structure design
- Long life ball bearing motor
- Metallic components within air stream provides extra safety against fire
- Reverse flow prevention shutter



Panasonic Ecology Systems Guangdong Co., Ltd. certifies that the Metal Series models shown herein are licensed to bear the AMCA Seal. The ratings shown are based on tests and procedures performed in accordance with AMCA Publication 211 and AMCA Publication 311 and comply with the requirements of the AMCA Certified Ratings Program.

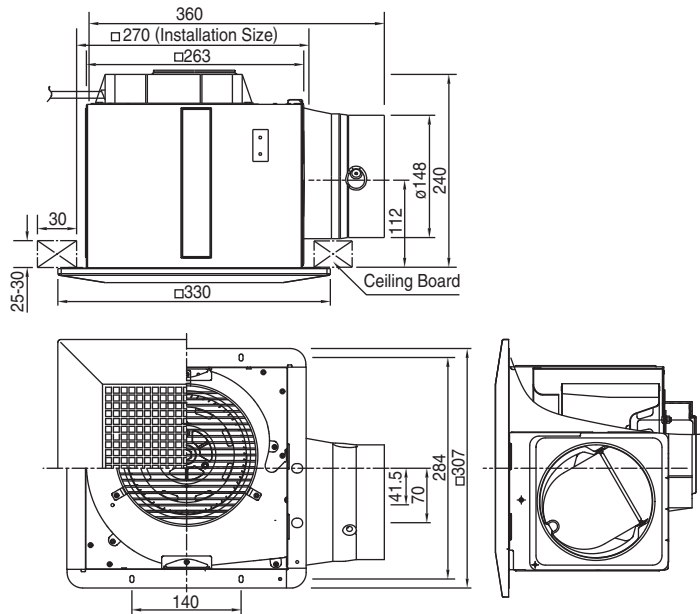

Model	Voltage [V]	Frequency [Hz]	CFM / SONE AT STATIC Pressure (ps-inches of H ₂ O)						RPM	Watts*	Watts**
			Inches of H ₂ O	0	0.1	0.125	0.25	0.375			
27CMHA	220	60	CFM	208	184	178	144	108	615	46	43
			Sones	1.6	1.7	1.7	2.3	3.2			
	240	50	CFM	219	194	188	150	110	669	46	43
			Sones	1.9	1.9	2.0	2.4	3.4			

Performance certified is for installation type B: Free inlet, Ducted outlet. Performance ratings include the effects of an inlet grille and backdraft shutter. Speed (RPM) shown is nominal. Performance is based on actual speed of test. The sound ratings shown are loudness values in fan sones at 5 ft. (1.5m) in a hemispherical free field calculated per AMCA International Standard 301. Values shown are for installation type B: Free inlet hemispherical sone levels.
* the Watts rating is only for AMCA test method and it is at the static pressure of 0 inch of H₂O.
** the Watts rating is only for IEC test method and the AMCA Certified Ratings Seal does not apply to IEC test method watts.

Standard Series



38CDG/38CDG 05

- High-Low speed selectable
- Condenser motor with thermal cut-off
- Well lubricated bearing for long life operation
- High performance sirocco fan



Panasonic Ecology Systems Guangdong Co., Ltd. certifies that the Standard models shown herein are licensed to bear the AMCA Seal. The ratings shown are based on tests and procedures performed in accordance with AMCA Publication 211 and AMCA Publication 311 and comply with the requirements of the AMCA Certified Ratings Program.

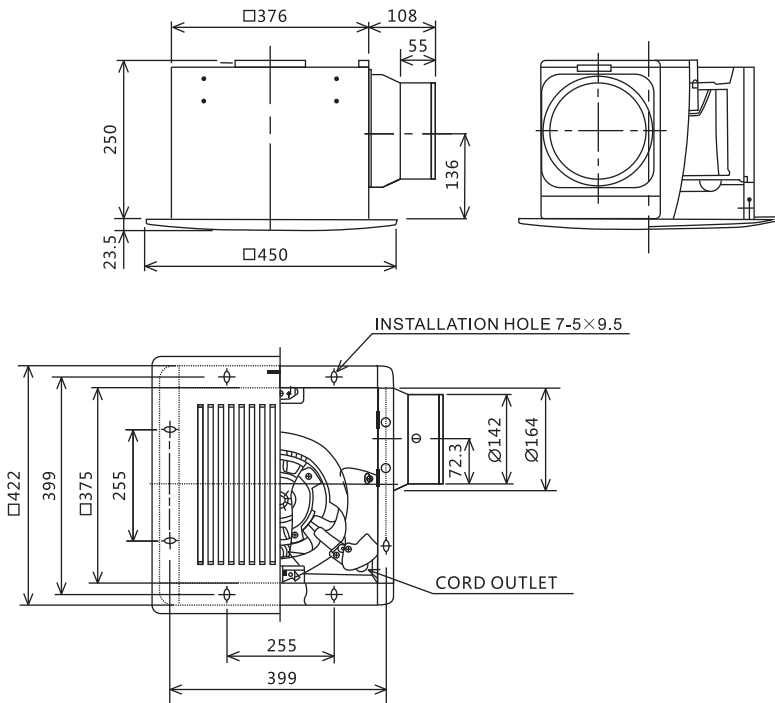

Model	Voltage [V]	Frequency [Hz]	Speed	CFM / SONE AT STATIC Pressure (ps-inches of H ₂ O)										RPM	Watts*	Watts**
				Inches of H ₂ O	0	0.1	0.125	0.25	0.375	0.5	0.625	0.75	0.875			
38CDG	220	60	Hi	CFM	344	323	317	290	261	230	197	163	126	626	98	98
				Sones	3.1	3.2	3.2	3.3	3.6	4.1	4.5	5.7	5.7			
38CDG 05 38CDG	240	50	Hi	CFM	387	367	362	336	305	259	212	165	108	737	118	104
				Sones	4.0	4.1	4.2	4.3	4.4	4.7	5.3	5.7	6.2			

Performance certified is for installation type B: Free inlet, Ducted outlet. Performance ratings include the effects of an inlet grille and backdraft shutter. Speed (RPM) shown is nominal. Performance is based on actual speed of test. The sound ratings shown are loudness values in fan sones at 5 ft. (1.5m) in a hemispherical free field calculated per AMCA International Standard 301. Values shown are for installation type B: Free inlet hemispherical sone levels.

* the Watts rating is only for AMCA test method and it is at the static pressure of 0 inch of H₂O.

** the Watts rating is only for IEC test method and the AMCA Certified Ratings Seal does not apply to IEC test method watts.

Specification

Series	Model	Voltage [V]	Frequency [Hz]	Speed	CFM / SONE AT STATIC Pressure (ps-inches of H ₂ O)										RPM	Watts*	Watts**
					Inches of H ₂ O	0	0.1	0.125	0.25	0.375	0.5	0.625	0.75	0.875			
Super Quiet Series	17CUH	220	60	-	CFM	44	32	29	-	-	-	-	-	-	664	10	10
					Sones	0.3	0.5	0.6	-	-	-	-	-	-			
		240	50	-	CFM	51	43	40	-	-	-	-	-	-	728	10	9.5
					Sones	0.3	0.4	0.5	-	-	-	-	-	-			
	24CUH	220	60	-	CFM	83	73	68	46	-	-	-	-	-	585	13	13.5
					Sones	0.4	0.5	0.6	1.3	-	-	-	-	-			
		240	50	-	CFM	89	77	75	51	-	-	-	-	-	614	13	12
					Sones	0.5	0.7	0.7	1.4	-	-	-	-	-			
	24CDH	240	50	-	CFM	106	93	89	65	-	-	-	-	-	782	17	16.5
					Sones	0.9	0.9	0.9	1.6	-	-	-	-	-			
	24CHH	220	60	-	CFM	109	99	96	75	48	-	-	-	-	791	22	20.5
					Sones	1.0	0.9	1.0	1.3	2.2	-	-	-	-			
		240	50	-	CFM	117	109	96	73	33	-	-	-	-	861	21	19.5
					Sones	1.2	1.2	1.2	1.3	1.8	-	-	-	-			
	24CGH	220	60	-	CFM	121	113	111	97	77	-	-	-	-	888	27	26.5
					Sones	1.7	1.8	1.8	2.0	2.6	-	-	-	-			
		240	50	-	CFM	130	118	115	90	43	-	-	-	-	955	27	25.5
					Sones	2.1	1.9	1.8	1.9	2.5	-	-	-	-			
	27CHH	220	60	Hi	CFM	182	162	156	118	78	37	-	-	-	570	33	33
					Sones	1.1	1.2	1.3	1.7	2.2	2.5	-	-	-			
		240	50	Hi	CFM	198	179	172	126	78	18	-	-	-	609	37	34
					Sones	1.4	1.5	1.6	1.8	2.3	2.5	-	-	-			
	32CDH	220	60	Hi	CFM	226	202	196	163	127	91	53	-	-	580	48	48
					Sones	1.2	1.3	1.4	1.7	2.2	2.7	3.3	-	-			
		240	50	Hi	CFM	257	236	230	192	147	99	53	-	-	675	56	50
					Sones	1.6	1.7	1.8	1.9	2.5	3.0	3.6	-	-			

Performance certified is for installation type B: Free inlet, Ducted outlet. Performance ratings include the effects of an inlet grille and backdraft shutter. Speed (RPM) shown is nominal. Performance is based on actual speed of test. The sound ratings shown are loudness values in fan sones at 5 ft. (1.5m) in a hemispherical free field calculated per AMCA International Standard 301. Values shown are for installation type B: Free inlet hemispherical sone levels.

* the Watts rating is for AMCA test method and it is at the static pressure of 0 inch of H₂O.

** the Watts rating is only for IEC test method and the AMCA Certified Rating Seal does not apply to IEC test method watts.

Specification

Series	Model	Voltage	Frequency	Speed	CFM / SONE AT STATIC Pressure (ps-inches of H ₂ O)										RPM	Watts*	Watts**			
		[V]	[Hz]		Inches of H ₂ O	0	0.1	0.125	0.25	0.375	0.5	0.625	0.75	0.875						
DC Motor Series	24JRB	220	60	Hi	CFM	88	88	88	88	63	34	5	-	-	853	10	8			
					Sones	0.7	1.0	1.0	1.3	1.7	1.8	3.1	-	-						
		240	50	Hi	CFM	88	88	88	88	63	34	5	-	-						
					Sones	0.7	1.0	1.0	1.3	1.7	1.8	3.1	-	-						
	24JAB	220	60	Hi	CFM	88	88	88	88	63	34	5	-	-	839	10	8			
					Sones	0.6	0.9	1.0	1.4	1.6	1.9	3.2	-	-						
		240	50	Hi	CFM	88	88	88	88	63	34	5	-	-						
					Sones	0.6	0.9	1.0	1.4	1.6	1.9	3.2	-	-						
Metal Series	24CMUA	220	60	-	CFM	55	40	37	20	-	-	-	-	-	495	13	12			
					Sones	0.3	0.7	0.8	1.6	-	-	-	-	-						
		240	50	-	CFM	55	44	41	24	-	-	-	-	-				562	14	13
					Sones	0.3	0.8	1.0	1.4	-	-	-	-	-						
	24CMHA	220	60	-	CFM	94	85	83	72	54	-	-	-	-	681	25	23			
					Sones	1.0	1.4	1.5	1.9	2.3	-	-	-	-						
		240	50	-	CFM	108	98	95	77	44	-	-	-	-				753	27	25
					Sones	1.4	1.8	1.9	2.1	2.2	-	-	-	-						
	27CMHA	220	60	-	CFM	208	184	178	144	108	79	-	-	-	-	615	46	43		
					Sones	1.6	1.7	1.7	2.3	3.2	3.5	-	-	-	-					
		240	50	-	CFM	219	194	188	150	110	70	-	-	-	-	669	46	43		
					Sones	1.9	1.9	2.0	2.4	3.4	3.1	-	-	-	-					
Standard Series	38CDG	220	60	Hi	CFM	344	323	317	290	261	230	197	163	126	626	98	98			
					Sones	3.1	3.2	3.2	3.3	3.6	4.1	4.5	5.7	5.7						
	38CDG 05 38CDG	240	50	Hi	CFM	387	367	362	336	305	259	212	165	108	737	118	107			
					Sones	4.0	4.1	4.2	4.3	4.4	4.7	5.3	5.7	6.2						

Performance certified is for installation type B: Free inlet, Ducted outlet. Performance ratings include the effects of an inlet grille and backdraft shutter. Speed (RPM) shown is nominal. Performance is based on actual speed of test. The sound ratings shown are loudness values in fan sones at 5 ft. (1.5m) in a hemispherical free field calculated per AMCA International Standard 301. Values shown are for installation type B: Free inlet hemispherical sound levels.

* the Watts rating is only for AMCA test method and it is at the static pressure of 0 inch of H₂O.

** the Watts rating is only for IEC test method and the AMCA Certified Ratings Seal does not apply to IEC test method watts.

Note

[illegible]